

Air Terminal Device

Air Valve

Metal Air Valves & Accessories1
 Plastic Air Valves6

Ceiling Diffuser

• Square Diffuser7
 CD-SA, CD-SC, CD-SP
 • Accessories of Square Diffuser8
 • Circular Diffusers9
 CD-RA, CD-RB, CD-RC, CD-RP, CD-RT
 • Swirl Diffusers11
 SD-A, SD-B, SD-CA, SD-CB, SW
 • Linear Diffuser14

Air Supply & Return Grilles

Eggcrate Grilles

**EG-A, EG-B, EG-Bi, EG-CA,
 EG-CB, EG-CAi, EG-CBi, EG-D**

Classic Line Wall Grille18
 Single Deflection Grille SG-A
 Double Deflection Grille DG-A

New Line Wall Grille19
 Single Deflection Grille SG-B
 Double Deflection Grille DG-B

Single Deflection Return Grille RG-A20
 Steel Air Return Grille RG-B21

Air Transfer Grille TG21
 Louver LV21

• Grilles Accessories22
 • Grille for Spiral Duct22

Circular Swirl Floor Diffuser FDS23

External Louver

• External Louver24
 VLA / VLB / VLD / SMS / SUA / SMS-P /
 SUA-P/ ELA / ELB / ELC / ELD/ELN/SMF

• Jet Nozzles JN-S, JN-D27

• Spherical Diffuser SPD28
 • **Turbovnt Rotary Chimney**29
 Cowl TB

Ducting System & Accessories

Flexible Ducting

• **Aluminum Foil/polyester**30
Flexible Ducting
 Alu---Aluminum Non-Insulated
 ISO---Aluminum Insulated
 Sono---Acoustic Aluminum Insulated
 • Alu/PVC Combined33
 Flexible Ducting

• Polyester Flexible Ducting34
 • Speed Clamp35
 • Clamp Band & Multi Clamp35
 • Nylon Clamp36

Duct Accessories

• **Spiral Clamp**37
 • Terrace Roof Stand TRS38
 • Suspension Band38
 • Dispenser Perforated Band38
 • Corner & Corner Clamp39
 • Holder40
 • Threaded Rod40
 • Beam Clamp40
 • Casting Pin40
 • Stiffening Steel Rod Cross41
 • Stiffening Rod Washer41
 Corner for Steel Louver41
 • Access Door42
 Curved Access Door CAD
 Flat Access Door FAD/RAD
 • Flexible Connector44
 Vinyl / Silicon
 Pipe / Fan Connector
 • Mounting Flange44
 • Sheet Metal Collar45
 • Self-Adhesive Pin45
 • Aluminum Foil & Aluminum
 Foil Tape46
 • PVC Duct Tape48
 • Cloth Duct Tape48
 • Gasket Tape48

Ventilating Damper & Accessories

• **Back Draught Shutters**49
PVA, PVB
 • **Iris Damper**50
 • One Blade Ventilating
 Damper52
 • **Ventilating Damper**
Hardware53

Metal Air Valves

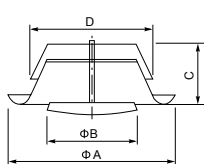

EV-S
 Stainless air valves

EV Exhaust Air Valves

- Suitable for offices, houses, etc, easy installation on the wall or in the ceiling.
- Manufactured from sheet steel painted white RAL9010 or RAL9016.
- Available also in Stainless steel version EV-S.
- The valve body is equipped with a cellular plastic gasket to form an air-tight seal.
- The air flow is adjusted by rotating the control disc.
- Supplied with mounting ring.
- **Packing: hardboard box in white or brown colour.**

EV	A	B	C	D	
80	115	62	42	77.5	7
100	138	75	40	97.5	7
125	164	100	46	122.5	7
150	202	120	50	147.5	7
160	211	130	54	157.5	7
200	248	158	63	197.5	7
250	305	215	75	248	7

SV Supply Air Valves

- Suitable for offices, houses, etc, easy installation on the wall or in the ceiling.
- Manufactured from sheet steel painted white RAL9010 or RAL9016.
- Available also in Stainless steel version SV-S.
- The valve body is equipped with a cellular plastic gasket.
- The air flow is adjusted by rotating the control disc.
- Supplied with mounting ring.

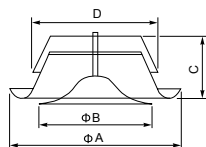

SV-S
 Stainless air valves

SV	A	B	C	D	
80	115	76	42	77.5	7
100	138	92	40	97.5	7
125	164	111	46	122.5	7
150	202	135	50	147.5	7
160	211	147	54	157.5	7
200	248	194	63	197.5	7
250	305	250	75	248	7

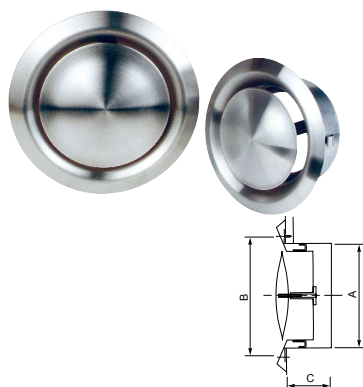

VS

- All Stainless steel 304 construction, excellent feature of antirust.
- Suitable for offices, houses, etc, easy installation on wall or in the ceiling.
- Distinguished good appearance.
- Applied for both return and supply air.
- The air flow is adjusted by rotating the control disc.
- Supplied with mounting ring.

VS	A	B	C	
80	75	97	40	100
100	97	118	52	60
125	120	141	52	30
150	145	162	62	24
160	155	172	62	24
200	195	228	74	24



NEV

- Suitable for offices, houses, etc, easy installation on wall or in the ceiling.
- Manufactured from sheet steel painted white RAL9010 or RAL9016.
- The valve body is equipped with a cellular plastic gasket.
- The air flow is adjusted by rotating the control disc.
- Supplied with mounting ring.

NEV	A	B	C	
80	114	62	37	7
100	134	77	40	7
125	165	101	46	7
150	195	121	54	7
160	198	121	54	7
200	247	160	64	7



NSV

- Suitable for offices, houses, etc, easy installation in the ceiling.
- Manufactured from sheet steel painted white RAL9010 or RAL9016.
- The valve body is equipped with a cellular plastic gasket.
- The air flow is adjusted by rotating the control disc.
- Supplied with mounting ring.

NSV	A	B	C	
80	114	95	37	7
100	134	112	40	7
125	164	137	46	7
150	195	160	54	7
160	195	160	54	7
200	247	207	64	7



Sanna Valves KEV-S

- Suitable for houses, offices etc.
- Can be opened and closed simply by pushing or pulling the wooden knob.

KEV

- Used for ventilation system with a low sound level even at high pressure drops.
- Manufactured from sheet steel painted white RAL9010 or RAL9016.
- The valve body is equipped with a cellular plastic gasket.
- The air flow can easily be adjusted by rotating the inner cone.
- Supplied with mounting ring.

KEV	A mm	C mm
100	136	77
125	162	87
150	193	91
160	193	91
200	243	109



Sanna Valves KSV-S

- Suitable for houses, offices etc.
- Can be opened and closed simply by pushing or pulling the wooden knob.

KSV

- Used for ventilation system with a low sound level even at high pressure drops.
- Manufactured from sheet steel painted white RAL9010 or RAL9016.
- The valve body is equipped with a cellular plastic gasket.
- The air flow can easily be adjusted by rotating the inner cone.
- Supplied with mounting ring.

KSV	A	B	C
100	145	67	18
125	175	76	19
160	218	80	20

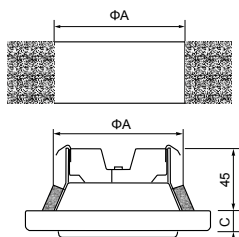

EVF

- Used for both exhaust and supply air , easy installation on wall or in the ceiling.
- Manufactured from sheet steel with a white powder-coated finish RAL9010.
- The valve body is equipped with a cellular plastic gasket.
- All sizes can be installed into the mounting frame or directly into the duct using its friction springs.
- The air flow can easily be adjusted by rotating the inner cone.
- Accessories: mounting ring type.

EVF	A	B	C
63	63	92	16
80	80	108	16
100	100	137	16
125	125	162	16
160	150	193	16
200	200	240	19

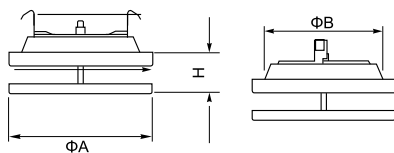

SVF

- Used for both exhaust and supply air , easy installation on wall or in the ceiling.
- Manufactured from sheet steel with a white powder-coated finish RAL9010.
- The valve body is equipped with a cellular plastic gasket.
- All sizes can be installed into the mounting frame or directly into the duct using its friction springs.
- The air flow can easily be adjusted by rotating the diffuser unit.
- Accessories: mounting ring.

SVF	H	A	B
80	27-57	108	80
100	27-57	137	100
125	27-57	162	125
160	27-57	193	160
200	27-60	240	200

Accessories for Metal Air Valves

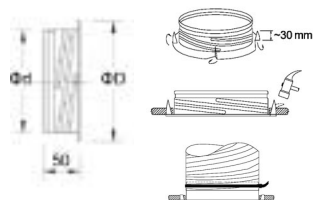

Mounting collar Type A

- Designed for use with EV/SV series metal air valves.
- Made of galvanized steel sheet employing the draw press technique.
- Quick and easy mounting with both spiral and flexible ducting.

Size	ΦD	Φd
80	105	79
100	125	99
125	150	124
150	175	149
160	185	159
200	225	199

Mounting collar Type B

- Designed for use with EV/SV series metal air valves.
- Made of galvanized steel sheet.
- Quick and easy mounting with both spiral and flexible ducting.



Size	ΦD	Φd
80	105	79
100	125	99
125	150	124
150	175	149
160	185	159
200	225	199

Mounting collar Type C

- Designed for use with KEV/KSV metal air valves.
- Made of galvanized steel sheet employing the draw press technique.
- Supplied with rubber gasket.

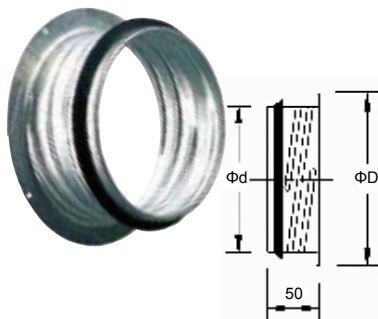

Size	ΦD	Φd
80	105	79
100	125	99
125	150	124
150	175	149
160	185	159
200	225	199

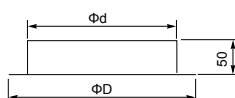

Mounting collar Type E

- Designed for use with air valves EVF,SVF.
- Designed for fast and easy mounting both with spiral and flexible ducting.
- Made of galvanized steel sheet.

Size	ΦD	Φd
80	105	79
100	125	99
125	150	124
150	175	149
160	185	159
200	225	199

Plastic Air Valves

VP

- Suitable for rooms with a high air humidity. (e.g. Kitchen, bathroom)
- Diameter 100, 125, 150, and 200 mm.
- Manufactured from polypropylene heat resistant to 100°C.
- Variable air flow control.
- No leakage between valve body and mounting frame.
- High valve body improving air flow/less noise with spring fastening.
- Simple removal for cleaning.
- For mounting in places with small spaces a clamping ring in added.



VP	Φ100	Φ125	Φ150	Φ200
A	80	100	118	171
B	148	168	186	240
C	87	106	130	178
D	20	20	20	20

