

Tubing Tool Kits



CT-808AM

CONTENTS OF KIT:

45°Eccentric Cone Type Flaring
Tool FOR 3/16", 1/4", 5/16",
3/8", 1/2", 5/8" & 3/4" and 5, 6, 8,
10, 12, 16 & 19mm O.D. Tubing.
CT-274:Tubing Cutter, CT-208:
Inner-Outer Reamer.



CT-275L

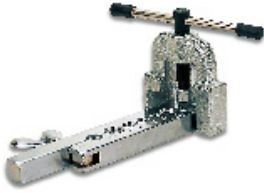
Flares 1/8", 3/16", 1/4", 5/16", 3/8",
7/16", 1/2", 5/8", and 3/4" O.D.
Includes 5 swage adapters which cover
3/16", 1/4", 5/16", 3/8", 1/2", 5/8", 3/4"
O.D.



CH-278L

Contains of kit:
CH-275 flaring & swaging tool.
CH-274 tube cutter, CH-122
ratchet wrench in plastic case.

Flaring Tool



CT-195

For 3/16", 1/4",
 5/16", 3/8", 7/16",
 1/2" and 5/8" O.D.
 Tubing.



CT-808A

Eccentric Cone Type for
 3/16", 1/4", 5/16", 3/8", 1/2",
 5/8", & 3/4" O.D. Tubing

CT-808M

Eccentric Cone Type
 for 5, 6, 8, 10, 12, 14, 16 &
 19mm O.D. Tubing



CT-525(45°)

Flares and burnishes imperial
 sizes 3/16" to 5/8" O.D.
 Tubing and metric sizes
 4.7 to 16mm O.D. Tubing

Tube Bender

Inch Size Tube Bender



Item No	Outside Diameter of Tubing in.	Nominal Size in.	Radius to Center of Tube in.
CT-364A-04	1/4	1/8	9/16
CT-364A-05	5/16	-----	1-1/16
CT-364A-06	3/8	1/4	1-5/16
CT-364A-08	1/2	3/8	1-1/2
CT-364A-10	5/8	1/2	2-1/4
CT-364A-12	3/4	5/8	3
CT-364A-14	7/8	3/4	3
CT-364M-04	6	14.2	9/16
CT-364M-05	8	17.5	1-1/16
CT-364M-06	10	24.0	1-5/16
CT-364M-08	12	38.1	1-1/2
CT-364M-10	16	57.2	2-1/4
CT-364M-12	19	76.2	3
CT-364M-14	22	76.2	3

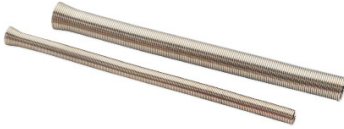


CT-368 3-IN-1

For 1/4", 5/16", 3/8" O.D. Tubing
90° degree bent.

CT-369 3-IN-1

180° degree bent.



Spring Bender

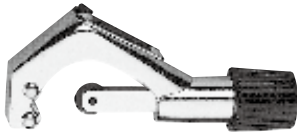
CT-102-04	Size 1/4"	Length 10"
CT-102-05	Size 5/16"	Length 10"
CT-102-06	Size 3/8"	Length 10"
CT-102-08	Size 1/2"	Length 12"
CT-102-10	Size 5/8"	Length 14"
CT-102-12	Size 3/4"	Length 14"

Tube Cutter



CT-274 Tube Cutter

1/8"~ 1-1/8" (4-28mm)



CT-312 Tube Cutter

CAPACITY: 1/4"~1-5/8" O.D. tubing



CT-105 Tube Cutter

CAPACITY : 1/8"~1-3/8" O.D. tubing



CT-107 Tube Cutter

CAPACITY : 1/4"~2" O.D. tubing



CT-127 Tube Cutter

1/8"~ 5/8"(4-15mm)



CT-174 "BigCT" Tube Cutter

3/8"~ 1-1/8"(10-28mm)

Tool Accessories



CT-208 Inner-Outer Reamer



CT-351 Fin straightener



CT-352 Steel Fin straightener



CH-122 Ratchet Wrench

1/4", 3/8", 3/16" and 5/16" square ratchet.

CH-123 Ratchet Wrench

1/4", 3/16" square 9/16", 1/2" Hex ratchet.



CT-204 Pinch Off Tool



**CT-128 Capillary Tube
Cutter**



CT-201 Pinch Off Plier 7"



PVC PIPE CUTTER

CH-42

Professional PVC cutter capacity up to 42mm.

CH-35

Professional PVC cutter capacity up to 35mm.



CT-95 Swagging Punches

for 1/4", 5/16", 3/8", 1/2" & 5/8" O.D.

5-in-1 punch



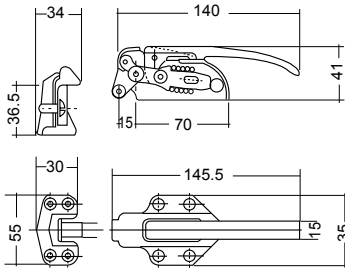
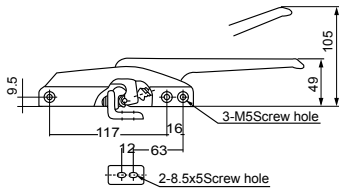
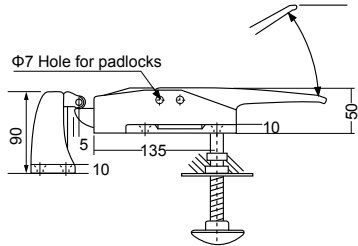
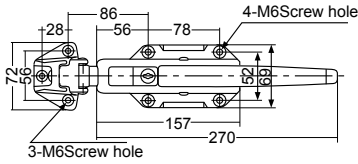
**CT-193 Set of 5 Swagging
Punches**

for 1/4", 5/16", 3/8", 1/2" & 5/8" O.D.



O' Rings & Gaskets

Latches & Hinge



CH-1178

Material: High pressure die-cast zinc.
 Finish: Highly polished chrome plated.
 Packing: 1 sets per box, then 12 boxes per carton.



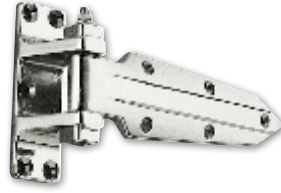
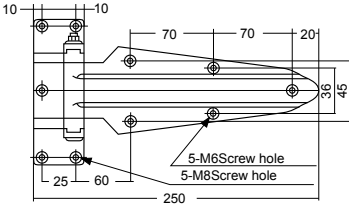
CH-1200B

Material: High pressure die-cast zinc.
 Finish: Highly polished chrome plated.
 Packing: 1 sets per box, then 30 boxes per carton.



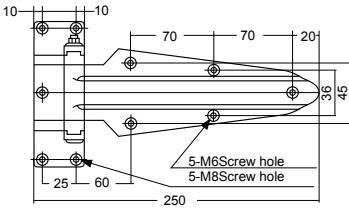
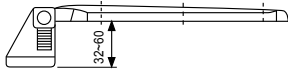
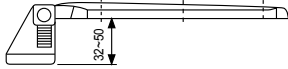
CH-1400B

Material: High pressure die-cast zinc.
 Finish: Highly polished chrome plated.
 Packing: 50 Sets per carton.



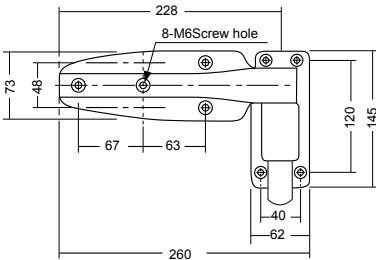
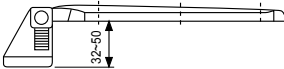
CH-1450 CH1460

Material: High pressure die-cast zinc.
 Finish: Highly polished chrome plated.
 Packing: 15 pairs per carton.
 CT-1450 from 32mm to 50mm
 CT-1460 from 32mm to 60mm
 Speciality: Can be used for left or right door.



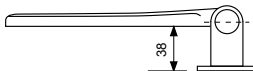
CH-1470

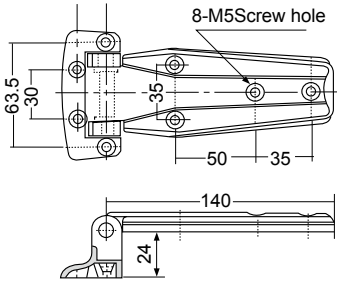
Material: High pressure die-cast zinc.
 Finish: Highly polished chrome plated.
 Packing: 10 pairs per carton.



CH-1238S

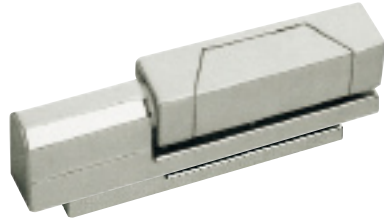
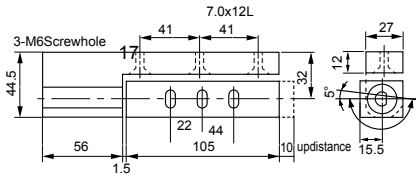
Material: High pressure die-cast zinc.
 Finish: Highly polished chrome plated.
 Packing: 20pcs (10 pairs) per carton.





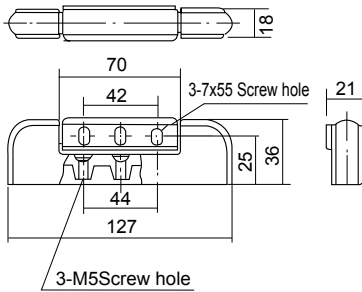
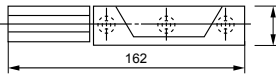
CH-1424

Material: High pressure die-cast zinc.
 Finish: Highly polished chrome plated.



CH-1132

Material: High pressure die-cast zinc.
 Finish: Highly polished chrome plated.
 Packing: 50 pcs(25 pairs) per carton.



CH-1336

Material: High pressure die-cast zinc.
 Finish: Highly polished chrome plated.
 Packing: 100 pcs(50 pairs) per carton.

Silver Solder



Soldering Alloys

SS	AWS A5.8	Ag	Cu	Zn	Ni	Sn	Other	SOLIDUS °F °C	LIQUIDUS °F °C	FLUIDITY RATING**
SS 0	BCuP-2		92.9				7.1P	1310-710	1475-802	5
SS 2	BCuP-6	2	91.0				7.0P	1190-643	1450-788	4
SS 5	BCuP-3	5	89.0				6.0P	1190-643	1500-816	3
SS 6		6	87.5				6.5P	1190-643	1425-774	5
SS 15	BCuP-5	15	80.0				5.0P	1190-643	1480-804	3
SS 25		25	43	30		2		1270-688	1435-779	5
SS 30	BAG-20	30	38	32				1250-677	1410-766	6
SS 35	BAG-35	35	32	33				1250-677	1350-732	5
SS 40		40	30.5	29.5				1250-677	1350-732	5
SS 45	BAG-5	45	30	25				1225-663	1370-743	6.5
SS 50	BAG-6	50	34	16				1270-688	1425-774	5.5
SS 54	BAG-13	54	40	5	1			1325-718	1575-857	4
SS 56	BAG-7	56	22	17		5		1145-618	1205-652	8
SS 72	BAG-8	72	28					1435-779	1435-779	

Silver Solder Flux



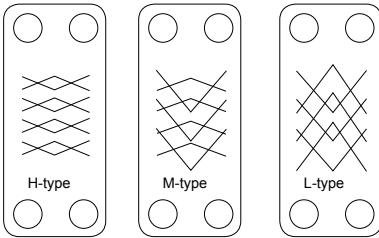
Powder flux and Liquid flux are available
Standard Packing: 4Oz/bottle and 24bottle
 in one master carton

Packing: in 25 lb bulk boxes, 28-stick tubes.

Brazed Plat Heat Exchanger Danfoss Qinbao

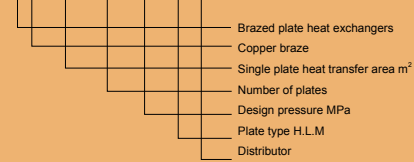


Plate Types H-M-L



Expression of The Type of BPHE

B3-052-50-3.0-H Q



BPHE B3-052 Dimensional Data

Number of plates	A (mm)	Weight(kg)	Channel volume (L) Q1 Q2 side/ Q3Q4 side	heat transfer area (m ²)
n	9+2.4n	1.8+0.23n	0.094xn/2 0.094x(n-2)/2	(n-2) 0.050

Technical Data

Design pressure	30 bar (A type)
	45 bar (A type)
Testing pressure	45 bar (A type)
	67.5 bar (A type)
Design temperature	-196~+200°C
Plate type	H.L.M
Heat load	10-60KW
Number of max plates	150

Heat Exchanger Channels

BPHE type B is available with different types of channel plates, which are responsible for the thermal characteristics of the heat exchanger.

The H-type plate has obtuse angles which result in higher heat transfer efficiency by increasing the turbulence of the fluid.

The L-type plate has acute angles. This reduces the pressure drop and leads to reduced turbulence and lower heat transfer efficiency.

The M-type plate is a combination of L and H plates. This solution can be used for applications, where the temperature change on one side of the BPHE is much larger than on the other.

Refrigeration

Air dried cooler
 Hot recycling dried device
 Oxyhy drogen generator

Heating

Hot water or heating system
 Hot water supply by boiler
 Hot water supply by vapor heater
 District heating

Heating

Oil cooler
 Other uses of cooler